

THE EB60. SEA CHANGE!

The EB60 is now in production!

Longer, sleeker, faster and more fuel efficient, this new model in the range is a contemporary version of the classic that created the 'DownEast' category.

Although not immediately apparent when she's sitting in the water, the EB60 is built on the world's most sophisticated hull design – the V-Warp®.

This guarantees that the '60 will be fast, stable in all conditions, highly manoeuvrable and unbelievably fuel efficient.



BEAM
19' 5.8 M

LENGTH OVERALL
68' 1" 20.74 M

TECHNICAL SPECS

Length Overall	68' 1"	20.74 M
Length On Deck	60' 10"	18.55 M
Beam	19'	5.8 M
Air Draft	16' 11"	5.14 M
Draft IPS	3' 9"	1.14 M
Draft Shafts	4' 1"	1.24 M
Displacement	59,500 LBS	27,000 KG

CAPACITY

Fuel Capacity	1,519 GAL	5,750 L
Water Capacity	300 GAL	1,100 L
Holding Tank	80 GAL	300 L

STANDARD ENGINES

	Volvo Penta IPS 950s @ 725 HP	
Draft	3' 9"	1.14 M
Top Speed	30 knots	
Cruise Speed	25 knots	
Range	894 nm / 36 GPH / 21 KN	

OPTIONAL ENGINES

	Volvo Penta IPS 1350s @ 1,000 HP	
Draft	3' 9"	1.14 M
Top Speed	38 knots	
Cruise Speed	30 knots	
Range	864 nm / 36 GPH / 21 KN	

EB60 SEDAN WITH LOWER GALLEY

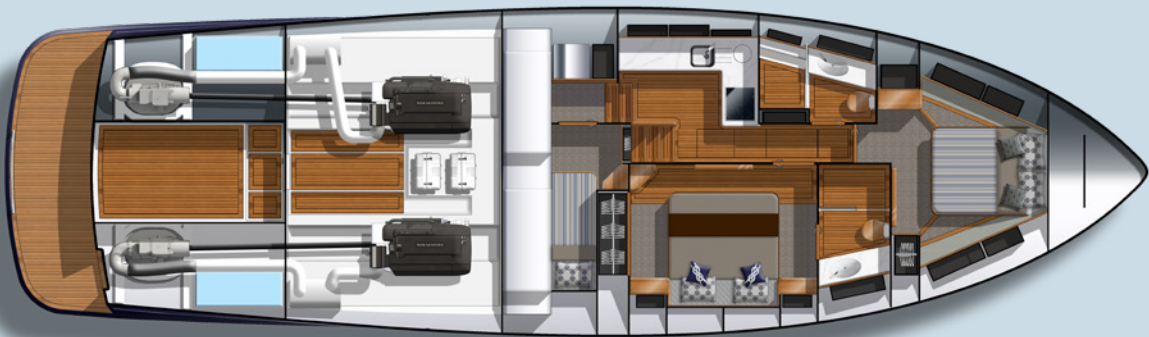
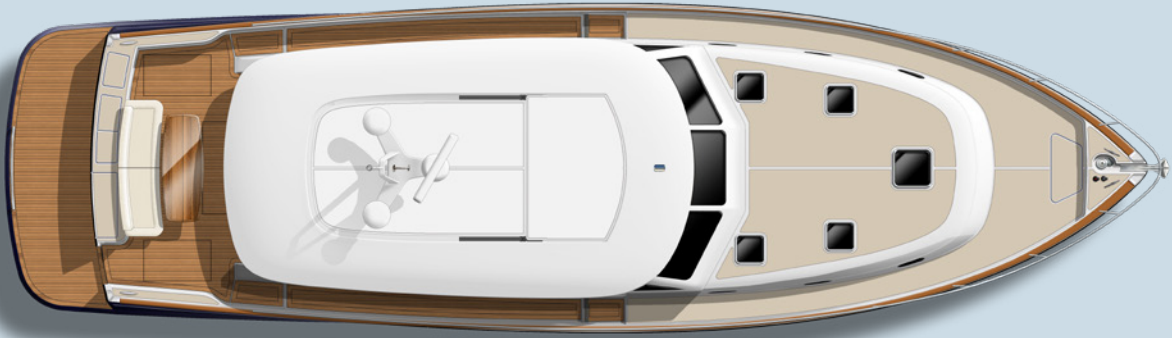

EB60 SEDAN WITH UPPER GALLEY

